

COPYRIGHT NOTES:
 1. THIS DRAWING AND ITS CONTENT IS COPY RIGHT PROTECTED AS AN ARTISTIC WORK (Section 2c), IN TERMS OF THE SA COPY RIGHT ACT No 98 OF 1978, IN ITS ENTIRETY.
 2. THIS DRAWING, ITS CONTENTS AND THE ACTUAL BUILDING IT PORTRAYS, MAY NOT BE ADAPTED, COPIED, DISTRIBUTED, DISTORTED, MODIFIED OR REPRODUCED IN ANY WAY OR FORM BY ANY PARTY, WHICH INCLUDES, BUT IS NOT LIMITED TO CLIENTS, CONSULTANTS OR ANY OTHER OR 3rd PARTIES, WITHOUT THE EXPRESS WRITTEN APPROVAL OF THE AUTHOR(S), BEING MBH ARCHITECTS Pty Ltd OR ANY OF ITS PRINCIPALS (Section 3a&b).
 3. THE ISSUING OF THIS DRAWING BY THE AUTHOR(S), TO ANY PARTY, WHICH INCLUDES, BUT IS NOT LIMITED TO CLIENTS, CONSULTANTS OR ANY OTHER OR 3rd PARTY, SHALL IN NO WAY CONSTITUTE, OR BE CONSTRUED OR IMPLIED TO CONSTITUTE AN EXCLUSIVE LICENSE OR SUB-LICENSE, NOR THE ASSIGNMENT OF COPYRIGHT, TO EXIST BETWEEN THE AUTHOR(S) AND THE PARTY IT IS ISSUED TO, AND SHALL IN NO WAY BE INFERRED BY CONDUCT (Section 22(4)) UNLESS REDUCED TO WRITING (Section 22(3)).
 4. THIS DRAWING AND ITS CONTENT, SHALL BE USED EXCLUSIVELY FOR THE ERECTING OF THE BUILDING AS PORTRAYED, ON THE BUILDING SITE SO MENTIONED IN THE TITLE BLOCK (Section 15(2)).

ISO 9001 : 2015 COMPLIANT

No.	Description	Date

Electrical Fixture Schedule		
Type Mark	Count	Level
5A Power Point for Electrical Fixture.	7	GROUND FLOOR
5A Power Point for Electrical Fixture.	12	FIRST FLOOR
5A Power Point for Electrical Fixture.: 19		
16A Power Outlet TYPE 1 to spec.	28	GROUND FLOOR
16A Power Outlet TYPE 1 to spec.	24	FIRST FLOOR
16A Power Outlet TYPE 1 to spec.: 52		
Grand total: 71		

5A Power Point for Electrical Fixture.	7	GROUND FLOOR
5A Power Point for Electrical Fixture.	12	FIRST FLOOR

5A Power Point for Electrical Fixture.: 19		
16A Power Outlet TYPE 1 to spec.	28	GROUND FLOOR
16A Power Outlet TYPE 1 to spec.	24	FIRST FLOOR

16A Power Outlet TYPE 1 to spec.: 52
 Grand total: 71

Lighting Device Schedule		
Type Mark	Count	Level
1 Lever Light Switch to spec.	6	GROUND FLOOR
1 Lever Light Switch to spec.	11	FIRST FLOOR
1 Lever Light Switch to spec.: 17		
2 Lever Light Switch to spec.	3	GROUND FLOOR
2 Lever Light Switch to spec.: 3		
3 Lever Light Switch to spec.	2	GROUND FLOOR
3 Lever Light Switch to spec.: 2		
Grand total: 22		

1 Lever Light Switch to spec.	6	GROUND FLOOR
1 Lever Light Switch to spec.	11	FIRST FLOOR

1 Lever Light Switch to spec.: 17		
2 Lever Light Switch to spec.	3	GROUND FLOOR

2 Lever Light Switch to spec.: 3		
3 Lever Light Switch to spec.	2	GROUND FLOOR

3 Lever Light Switch to spec.: 2
 Grand total: 22

1 Lever Light Switch to spec.
 EXISTING

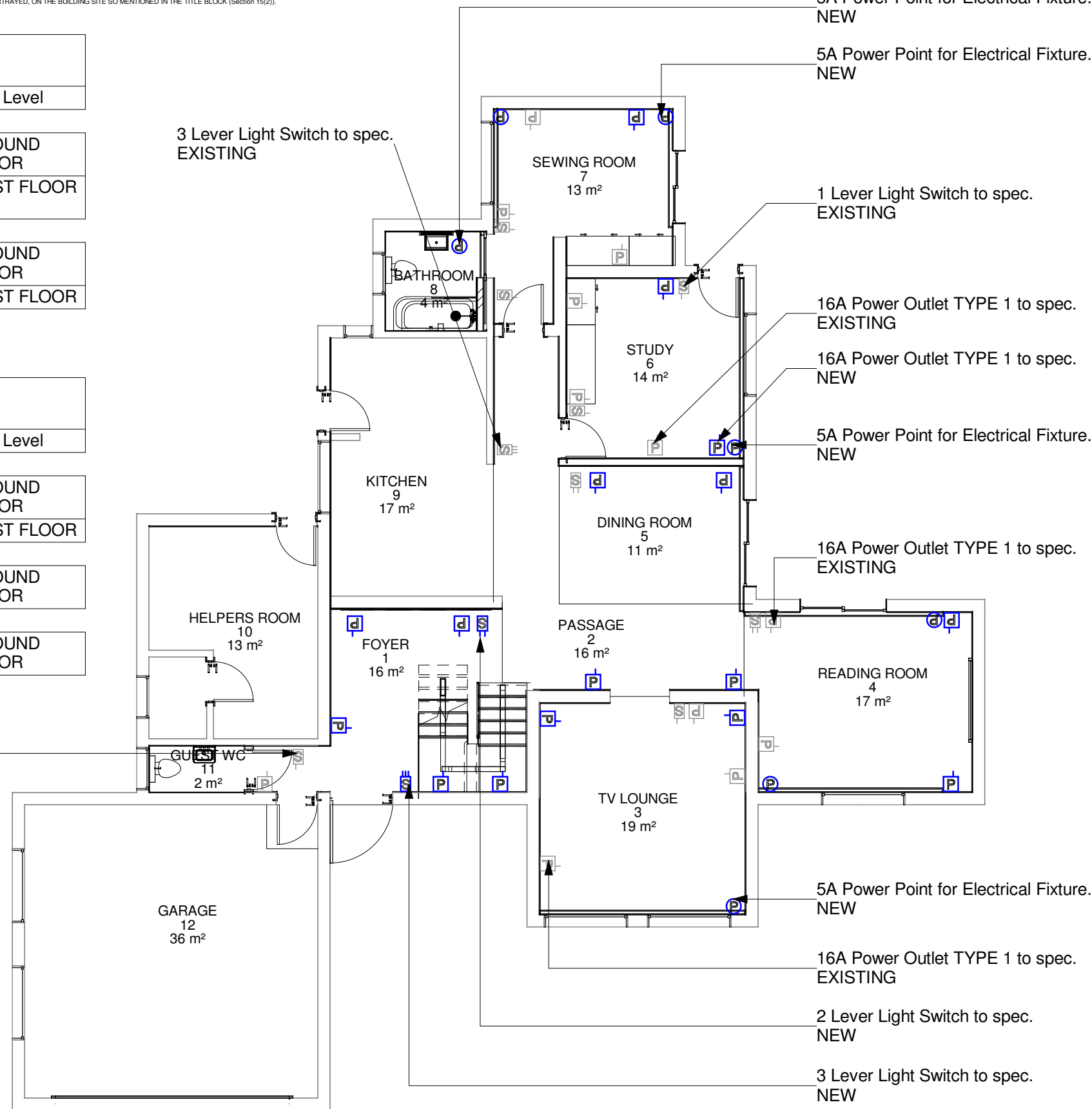

ISSUED FOR CONSTRUCTION

mbh International Sp. z o.o.

POLAND, EU

Architects, Interior & Industrial Designers
 +48 533 942 111 mbh.international.pl@gmail.com
 www.mbh-architects.com

LEVEL 1 B-BBEE Contributor

mbh Architects (Pty) Ltd

SOUTH AFRICA

Architects, Interior Designers & Industrial Designers
 +27 83 406 4988 - mbharchitectssa@gmail.com
 www.mbh-architects.com

CLIENT NAME	Mr Franz Rossbacher
-------------	---------------------

PROJECT NAME and ADDRESS	House Rossbacher, 882 Carlswald North Estate
--------------------------	--

DRAWING NAME	GROUND FLOOR - ELECTRICAL LAYOUT
--------------	----------------------------------

Drawing Issue Date	21 APRIL 2025
--------------------	---------------

Project Architect	MH
-------------------	----

SACAP Reg No	20695
--------------	-------

Drawn by	MH
----------	----

DRAWING NUMBER	114-B
<small>SHEET No-STOREY-BUILDING-UNIT-SECTION-DISCIPLINE-WORK STAGE REVISION No</small>	

PROJECT No	RES 25-04
------------	-----------

Scale	1 : 100
-------	---------

Sheet Size	A3
------------	----

1 **GROUND FLOOR - Electrical**
 1 : 100

NOTE : LOOSE FURNITURE & EQUIPMENT IS SHOWN FOR ILLUSTRATION PURPOSES ONLY. THIS DOES NOT FORM PART OF THE BUILDING PROJECT, UNLESS SPECIFIED.

2025/04/24 03:54:51 PM